



Shadow-R
2019 Assembly Guide



Shadow-R

2019 Assembly Guide



Shadow-R

2019 Assembly Guide

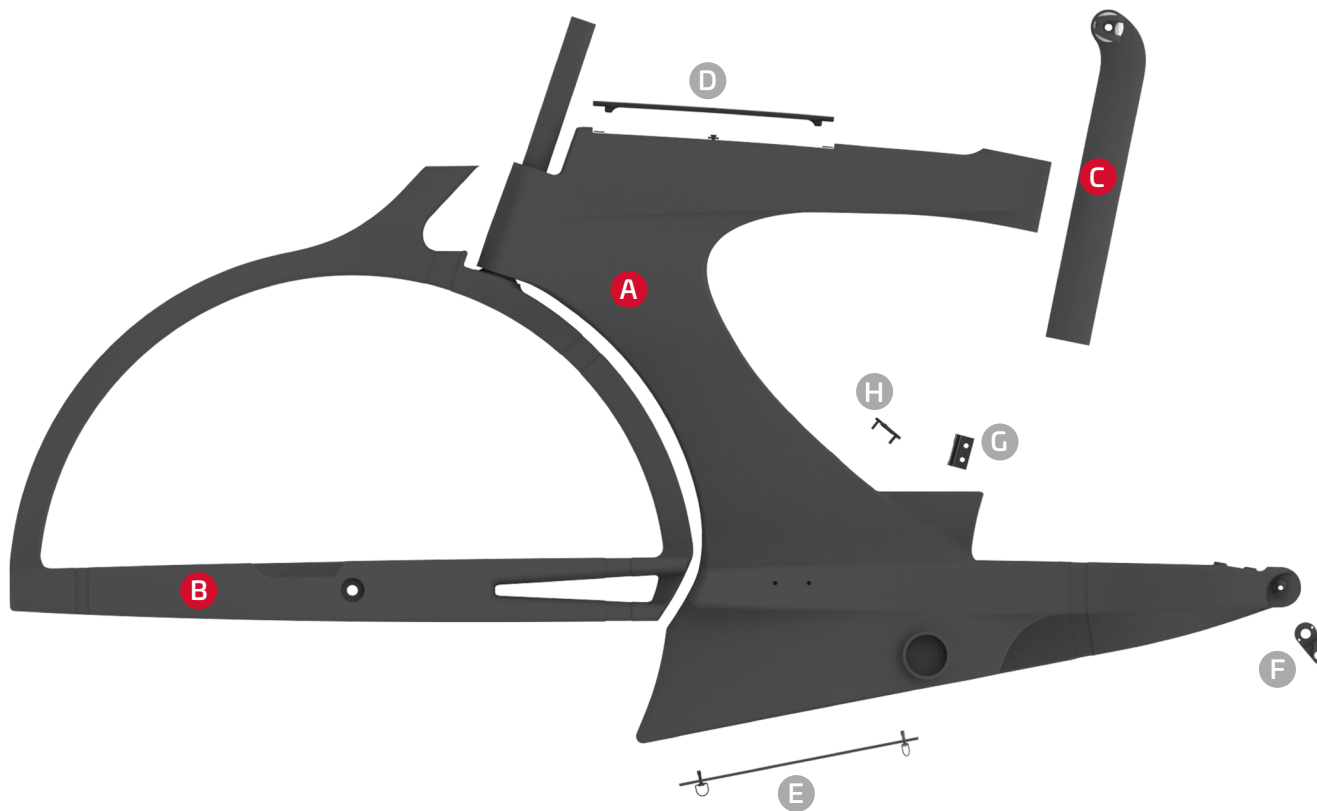

TABLE OF CONTENTS

1. Frameset Parts	4
2. Parts included in the BOX.....	5
3. Cables Map - Brakes.....	6
4. Cables Map - Front Derailleur	7
5. Cables Map - Rear Derailleur	8
6. Headset Installation	9
7. Di2 Battery Installation.....	10
8. Seatpost Installation.....	11
9. Front Derailleur Holder Installation.....	13
10. Frame Plugs Installation.....	14
11. TOOLBOX Installation	15
12. Bento BOX.....	16

Shadow-R

2019 Assembly Guide



1. Frameset Parts

- A** 40T high-modulus carbon frame
- B** 40T high-modulus carbon SideFork
- C** 40T high-modulus carbon Reversible Seatpost
- D** Bento Box rubber Lid
- E** TOOLBOX Lid
- F** Removable Rear Derailleur Hanger
- G** Removable Front Derailleur Hanger
- H** Di2 Junction Access Lid

Shadow-R

2019 Assembly Guide



2. Parts included in the BOX



- A Rear thru axle
- B Front thru axle
- C Headset including Canecreek Viscoset
- D Expander
- E Di2 battery adaptor
- F Mini clamp
- G Grommet for rear shifting (1 pc)
- H Grommet for e-Tap shifting (2 pcs)
- I Grommet for Di2 shifting (2 pcs)
- J Grommet for SRAM eTap (empty hole) (1 pc)

Shadow-R

2019 Assembly Guide

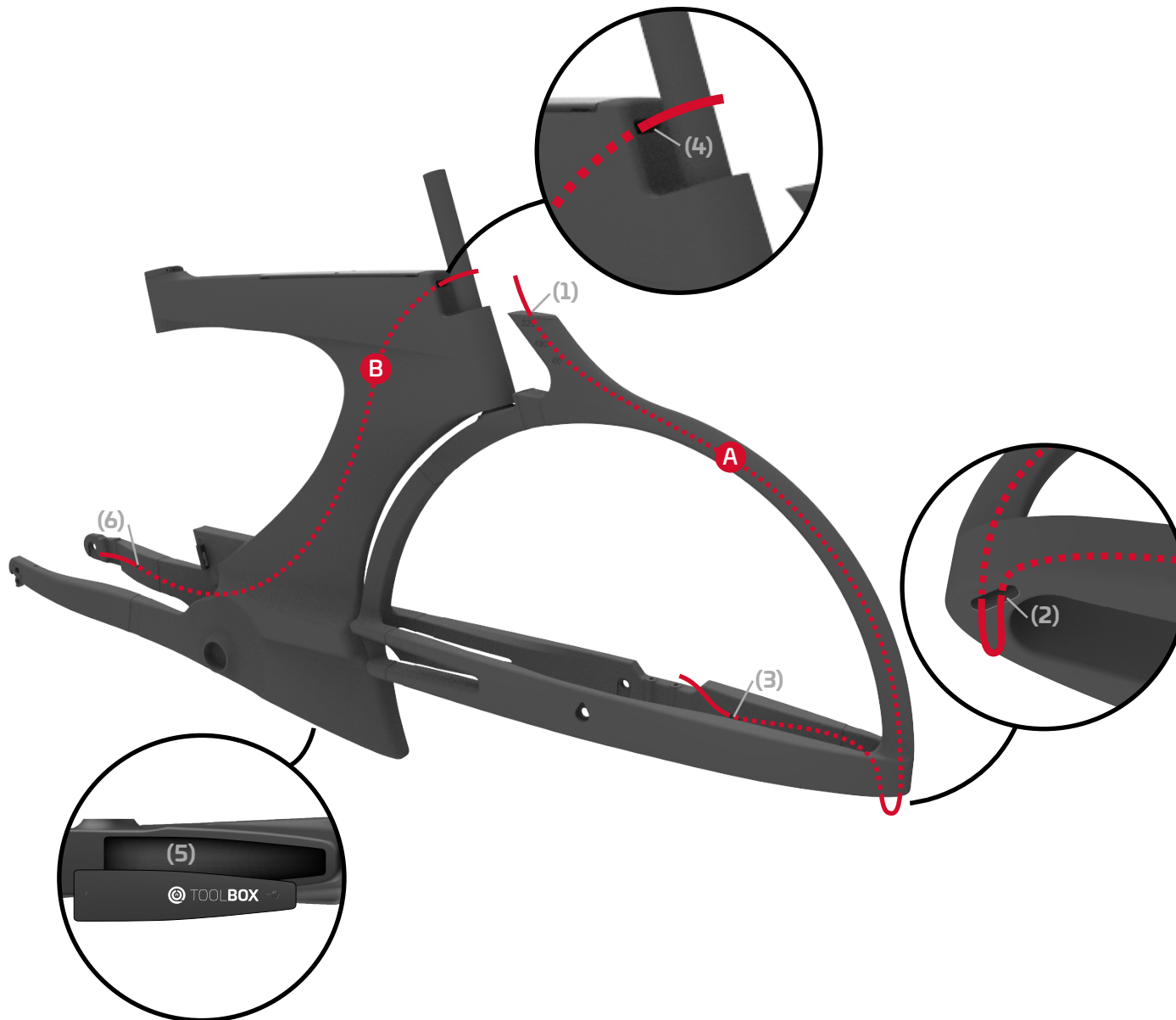

3. Cables Map - Brakes

A Front Brake Cable

Enter outer casing by hole located behind nose cone (1). Push casing inside until it reaches (2) opening where you can reach and help thread casing toward exit hole (3).

B Rear Brake Cable

Cable entry (4) is located behind stem. Thread the cable casing into hole until you can grab it through tool box opening (5), then guide it toward brake cable exit (6).



Pay attention to leave enough cable slack so you can pack the bike for travel and remove bars if needed.



No special parts or tools needed.

Shadow-R

2019 Assembly Guide



4. Cables Map - Front Derailleur

A Map Front Derailleur

Enter electric cable by hole located behind nose cone (1). Thread the electric cable into frame until you can grab it through tool box opening (2), then guide it toward brake cable exit (3).

This frameset is compatible with:

- All electric groups
- All 1By groups



No MECHANICAL Front Derailleur possible.

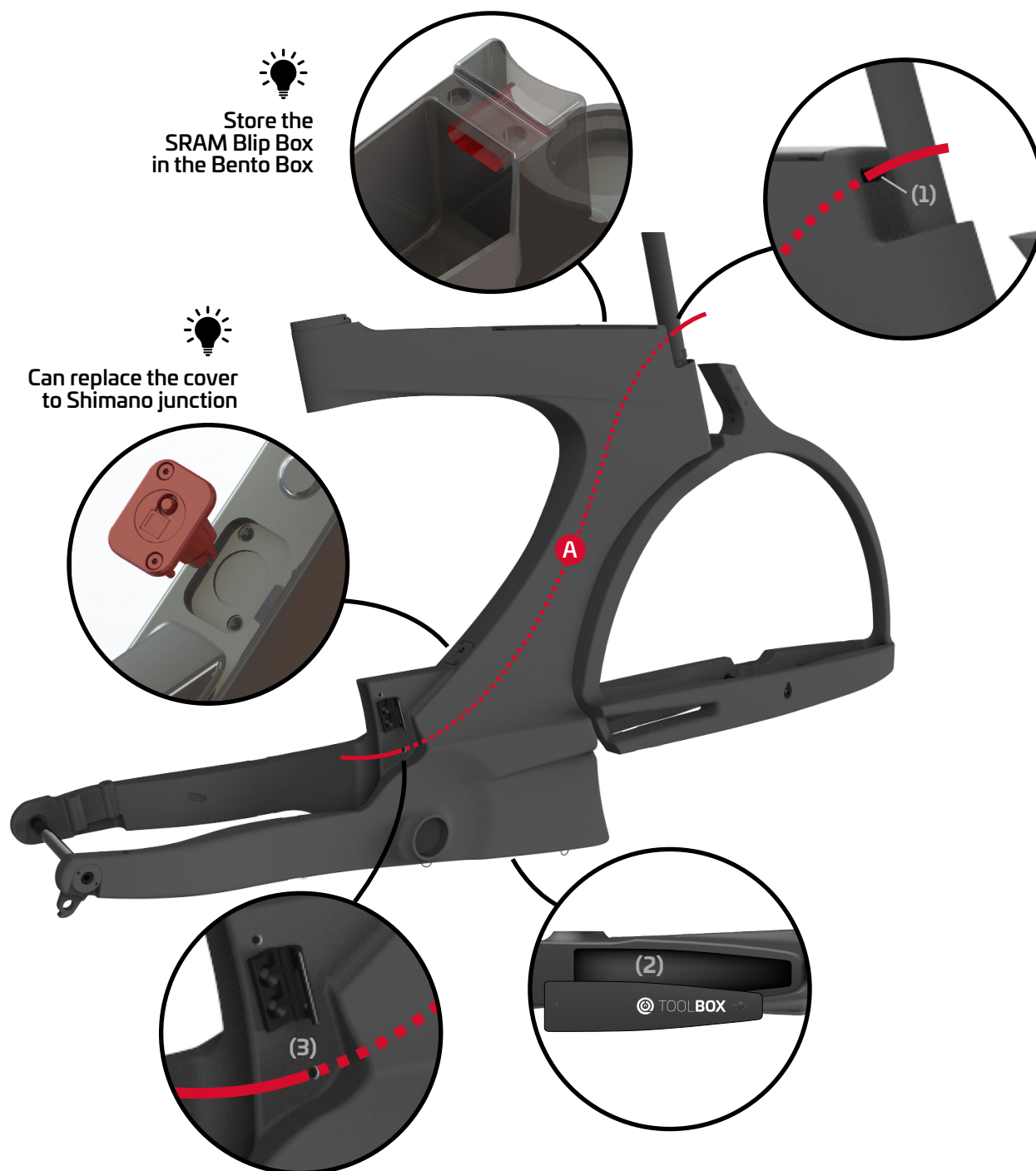

Store the
SRAM Blip Box
in the Bento Box

Can replace the cover
to Shimano junction

Shadow-R

2019 Assembly Guide



5. Cables Map - Rear Derailleur

B Map Rear Derailleur (mechanical)

Enter electric cable by hole located behind nose cone (1). Thread the electric cable into frame until you can grab it through tool box opening (2), then guide it toward brake cable exit (3).

C Map Rear Derailleur (Di2)

Enter electric cable by hole located behind nose cone (1). Thread the electric cable into frame until you can grab it through tool box opening (2), then guide it toward brake cable exit (4).



You will need to remove the derailleur hanger to have access to the Di2 cable exit hole.

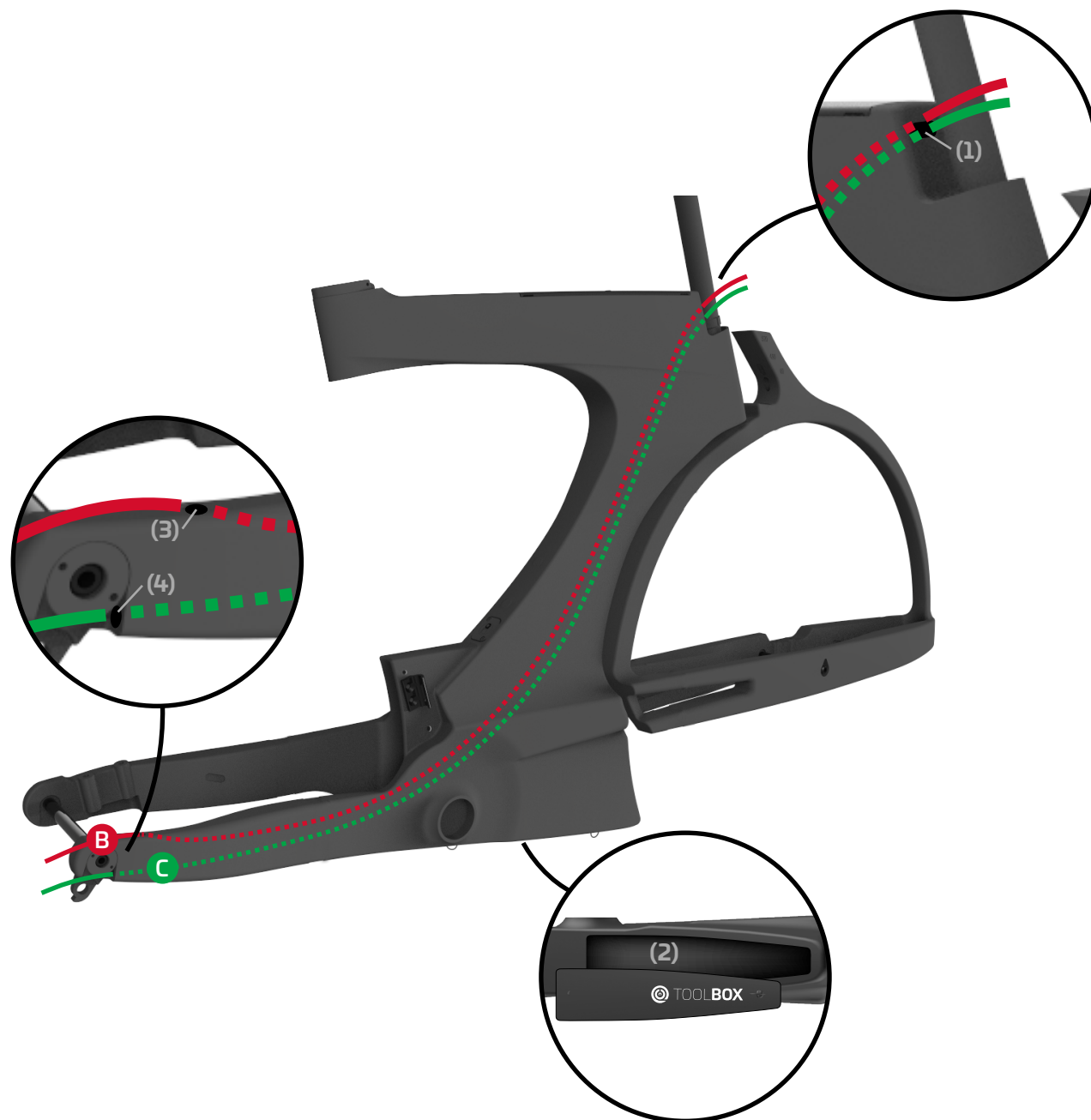

Shadow-R

2019 Assembly Guide



6. Headset Installation

The Ceepo Side Fork design is extremely unique and non-conventional. Because of the engineering behind the design, Ceepo provides a special "Cane Creek Viscoset" headset which is required to be used when assembling the Ceepo Shadow-R. Installing the special Cane Creek headset helps to ensure safe handling.



Please note that the use of any other headset is NOT authorized by Ceepo for installation on the Shadow-R or any other side fork equipped frameset.

Shadow-R

2019 Assembly Guide



7. Di2 Battery Installation

Step 1

Secure battery in the provided battery holder.

Step 2

The tool box opening (1) allows mechanics to hold the battery in place by hand while screws are put in place to hold battery assembly inside.



We suggest to tape or tie wrap excess cable and Shimano junction to the battery before installation.

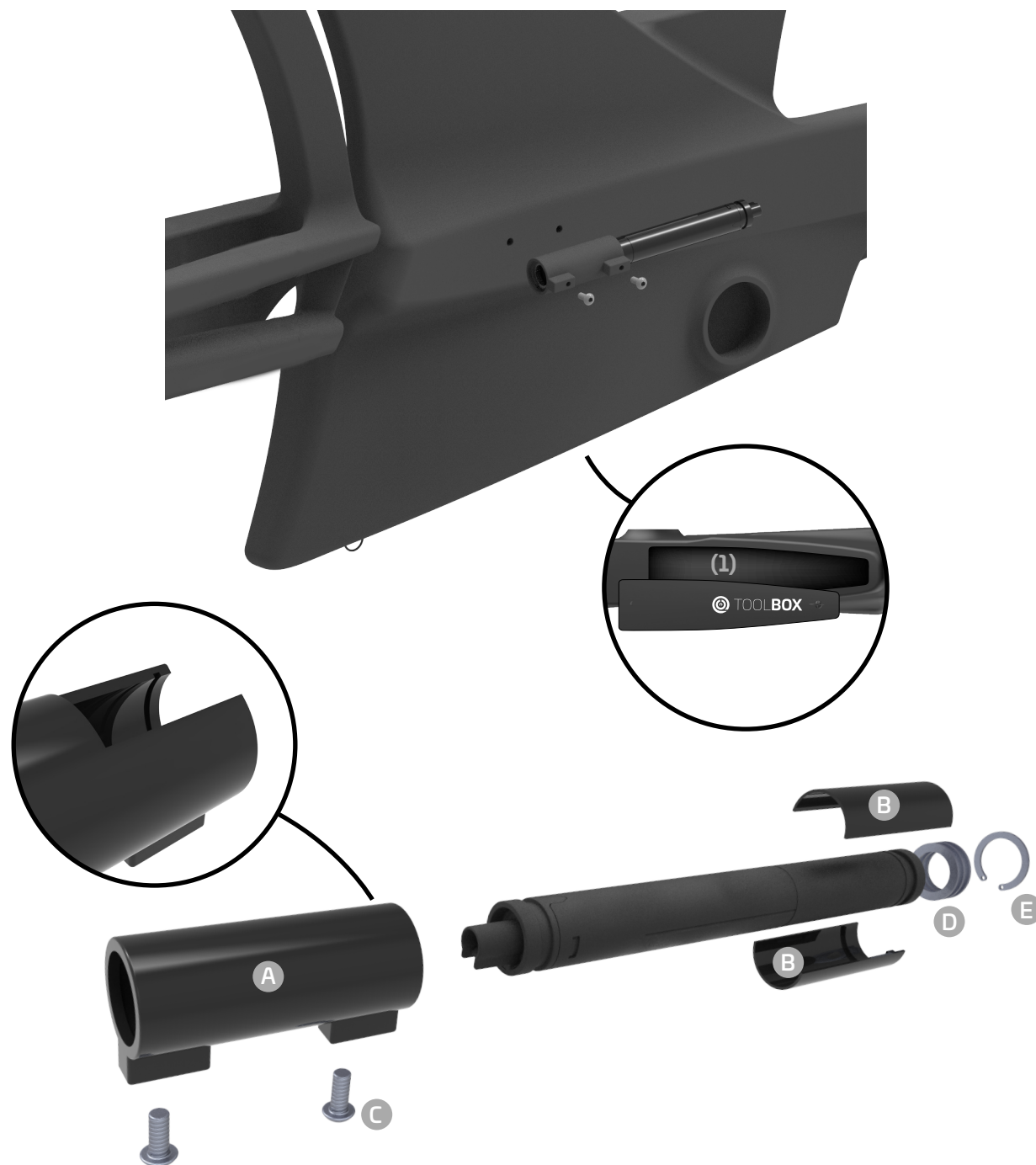

- A Di2 Battery Holder
- B Di2 Battery Collar
- C Adaptor Bolts
- D Washer
- E Internal Circlip

Shadow-R

2019 Assembly Guide

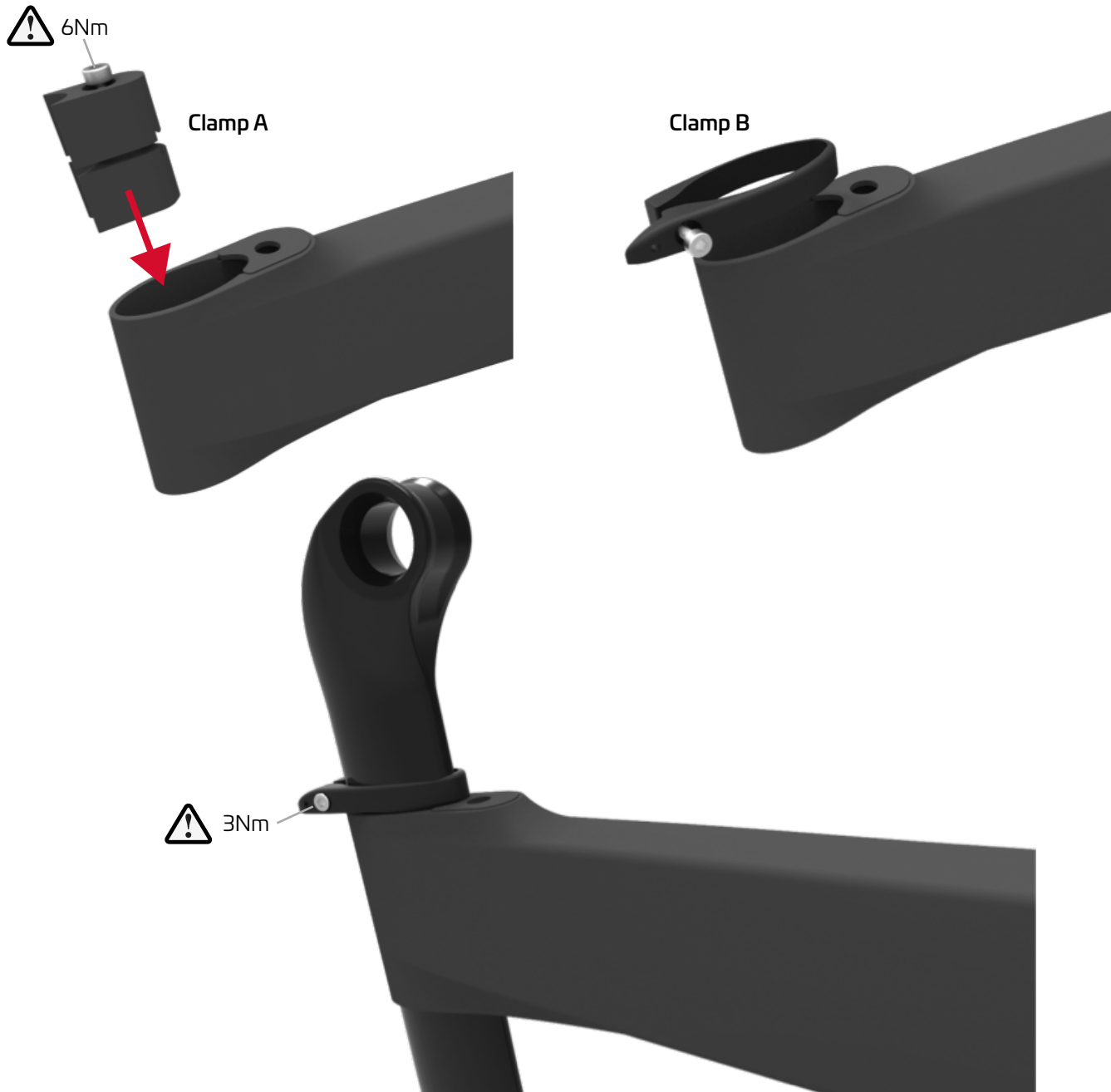

8. Seatpost Installation

Ceepo reversible seat post is secured via 2 clamps.

Clamp A

Wedge type must be placed inside clamp pocket inside frame, paying attention to have access to Allen key bolt head so you can tighten it.

Clamp B

Our Mini-clamp is to be placed on seat post prior to Installation.



This small clamp remains on seat post when removing it for travel.

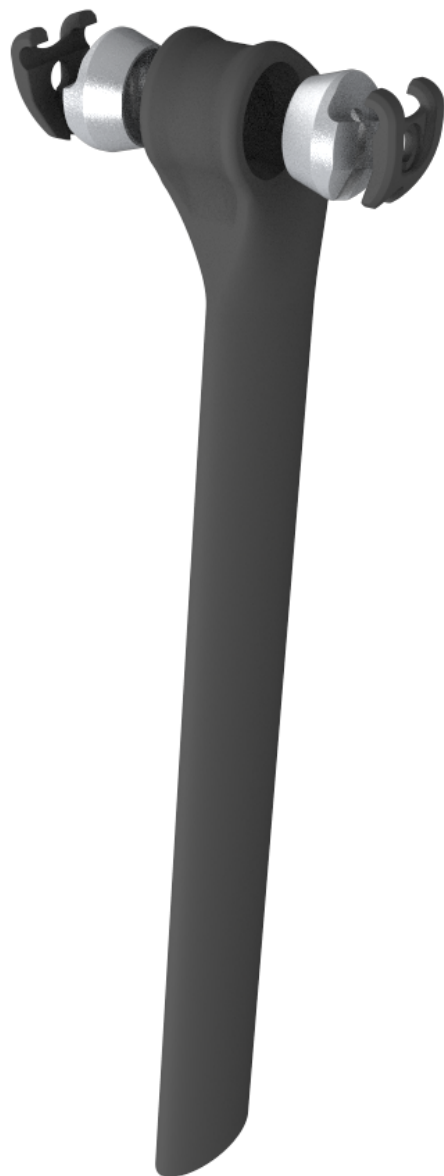

Shadow-R

2019 Assembly Guide



8. Seatpost Installation



Ceepo new reversible seat post is only for Alu railed saddle. If for carbon railed saddle, please buy the special outer cap from Ceepo.



Non-serrated for Infinite seat angle adjustment.

Shadow-R

2019 Assembly Guide



9. Front Derailleur Holder

Dual position



Will accept most chainrings ; including big oval ones.



Shadow-R 2019 Assembly Guide



10. Frame Plugs Installation

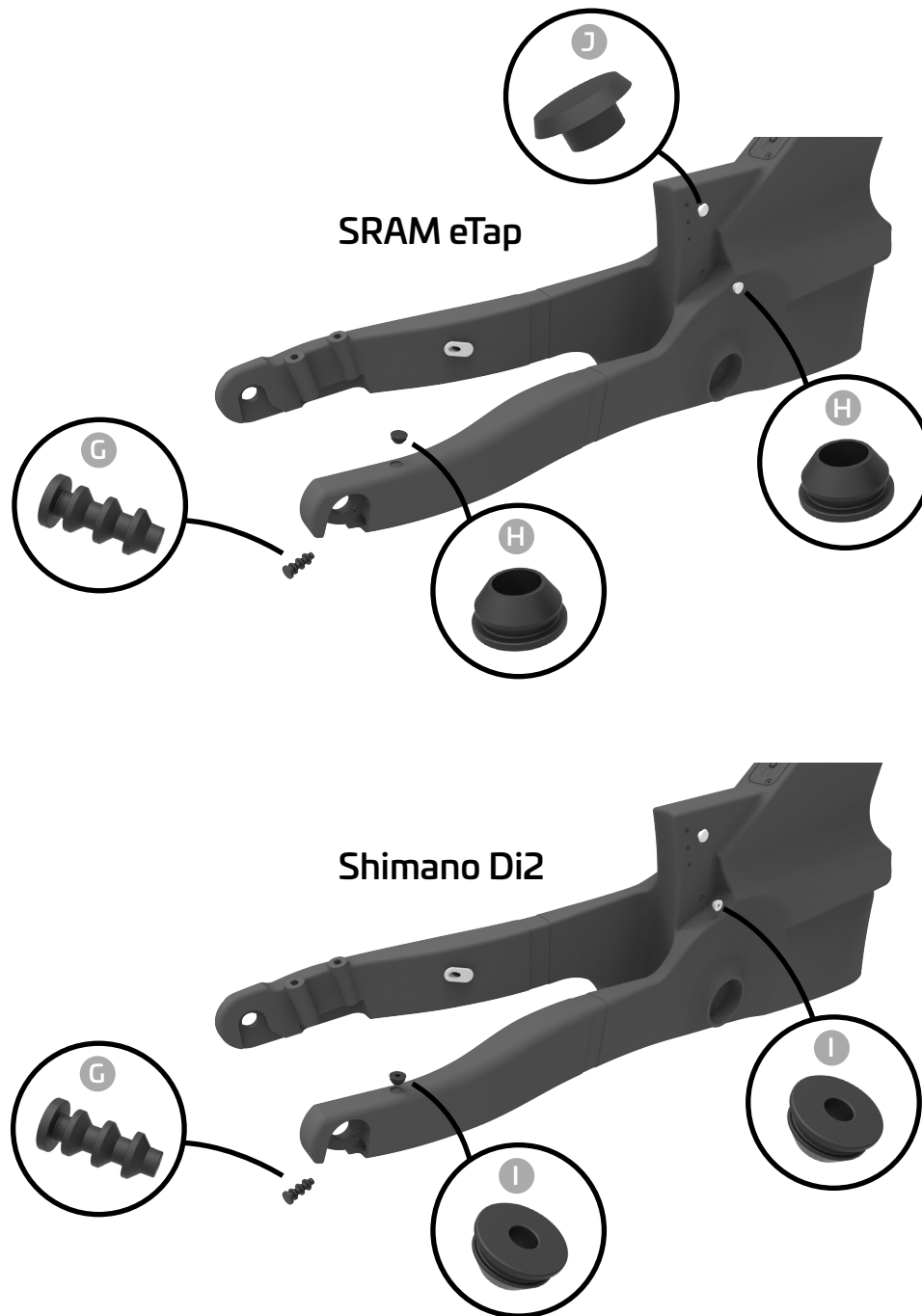

This PLUG should be already installed.

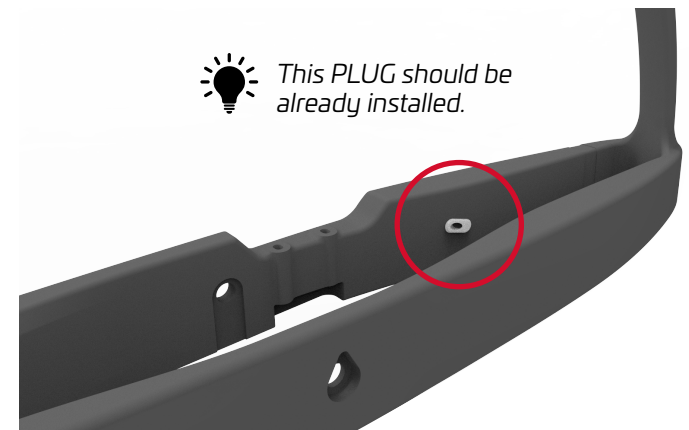

Shadow-R

2019 Assembly Guide



11. TOOLBOX Installation

Step 1

Velcro tool bag on the lid..

Step 2

Push it inside the frame and secure it using the 2 quick lock.



Pay attention to check quick lock engagement before riding. One side unlocked may result in loss of tool box riding, endangering rider and other cyclists along the way.

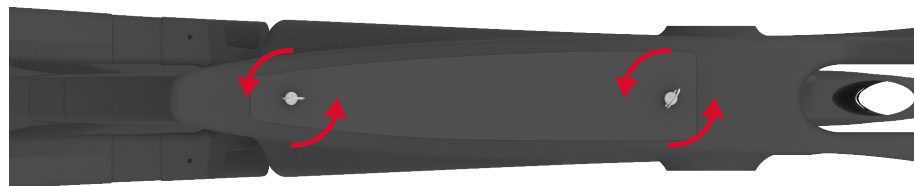

Tool Bag

Put tools inside mesh pocket

Insert Co2 cartridge inside the slots.

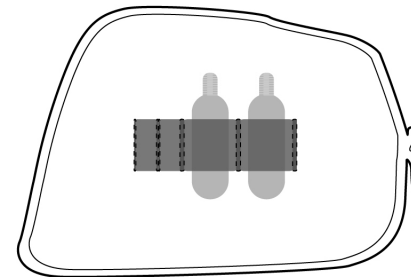
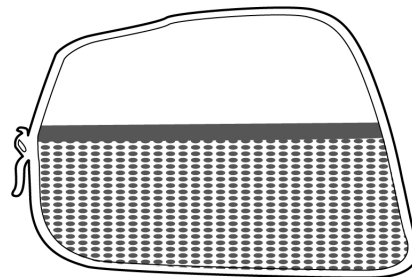

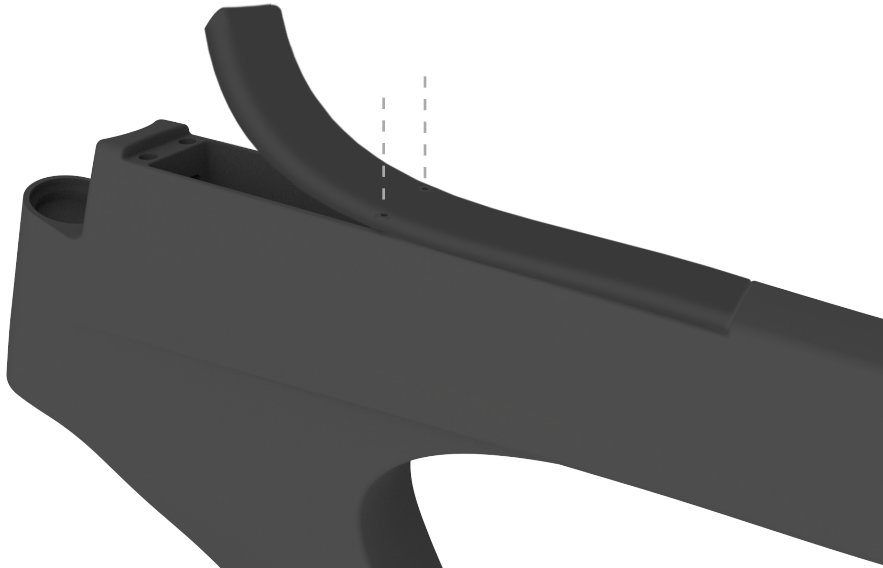

12. Bento BOX

Secure bento box cover at middle section.



*Bento is designed to open front and back
Magnets keep the cover closed while riding.*

